

4

3

2

1

NOTE:

- ALL DIMENSIONS IN MILLIMETERS / KILOGRAMS
- ALL MATERIAL MILD STEEL
- SEE OTHER SHEET FOR PART DETAILS; WELDING DETAILS WILL BE REVEALED ON COMPETITION DAY
- BEFORE WELDING, UPON COMPLETION OF FITUP, OBTAIN SIGN-OFF FROM TECHNICAL CHAIR
- COMPETITION PROJECT MAY DIFFER SLIGHTLY

NOTA:

- TOUTES LES DIMENSIONS EN MILLIMÈTRES / KILOGRAMMES
- TOUS LES MATÉRIAUX EN ACIER DOUX
- VOIR AUTRE PAGE POUR LES DÉTAILS DES PIÈCES ; SOUDAGE LES DÉTAILS SERONT RÉVÉLÉS EN CONCOURS JOUR
- UNE FOIS LE MONTAGE TERMINÉ, OBTENEZ L'APPROBATION DU PRÉSIDENT TECHNIQUE
- AVANT LE SOUDAGE, UNE FOIS L'AJUSTEMENT TERMINÉ, OBTENIR L'APPROBATION DU PRÉSIDENT TECHNIQUE
- LE PROJET DU CONCOURS PEUT DIFFÉRER LÉGÈREMENT

BILL OF MATERIALS

ITEM / ARTICLE	DESCRIPTION	QTY	KG
A	PL 9.53 X 310 X 375	1	8.7
B	PL 6.35 X 120 X 180	2	2.2
C	PL 6.35 X 128 X 248	2	3.2
D	PL 6.35 X 60 X 248	2	1.5
E	PL 6.35 X 133 X 248	1	1.6
F	PL 6.35 X 133 X 154	1	1.0
G	PL 6.35 X 85 X 142	1	0.6
H	PL 6.35 X 53 X 92	2	0.5
J	PL 6.35 X 101 X 342	1	1.7
K	PL 6.35 X 124 X 265	1	1.6
L	PL 9.53 X 50 X 310	1	1.2
TOTAL ESTIMATED WEIGHT / POIDS TOTAL ESTIMÉ:			23.8

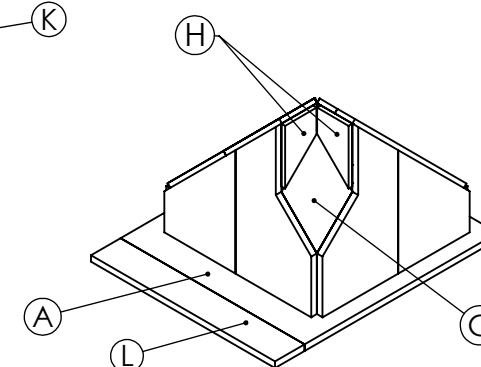
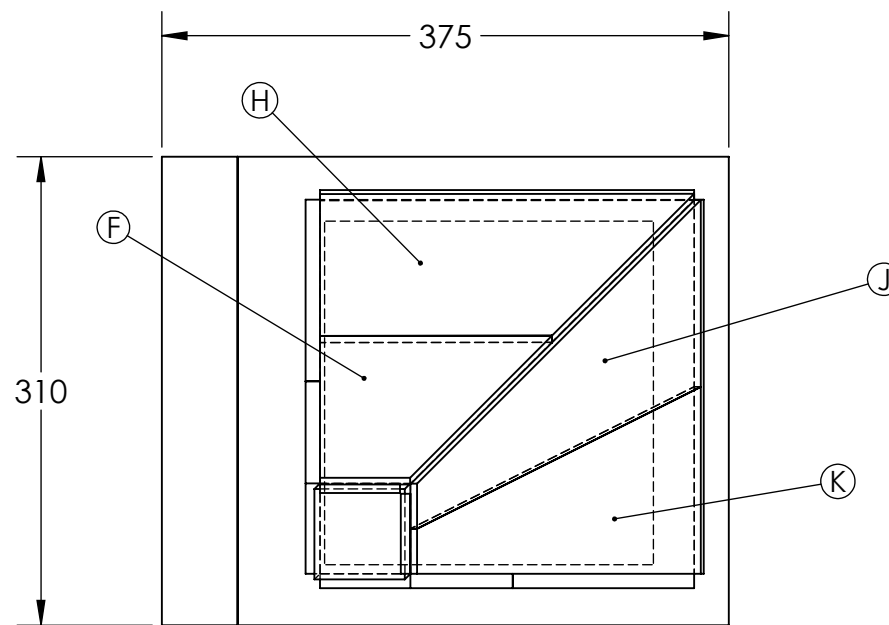

ISOMETRIC VIEW A / VUE ISOMÉTRIQUE A
SCALE 1:9

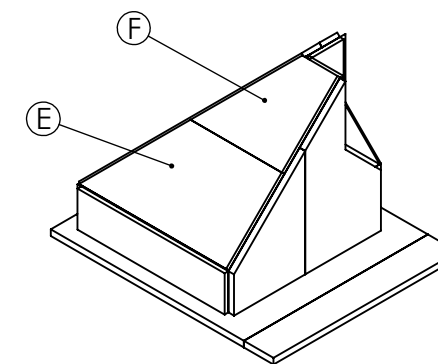

ISOMETRIC VIEW C / VUE ISOMÉTRIQUE C
SCALE 1:9

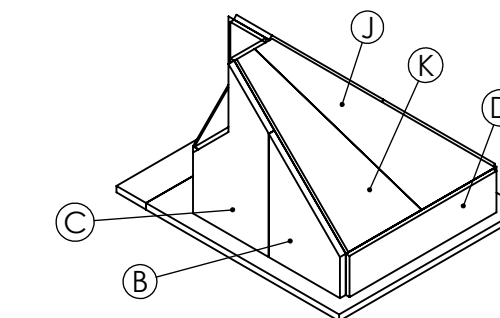
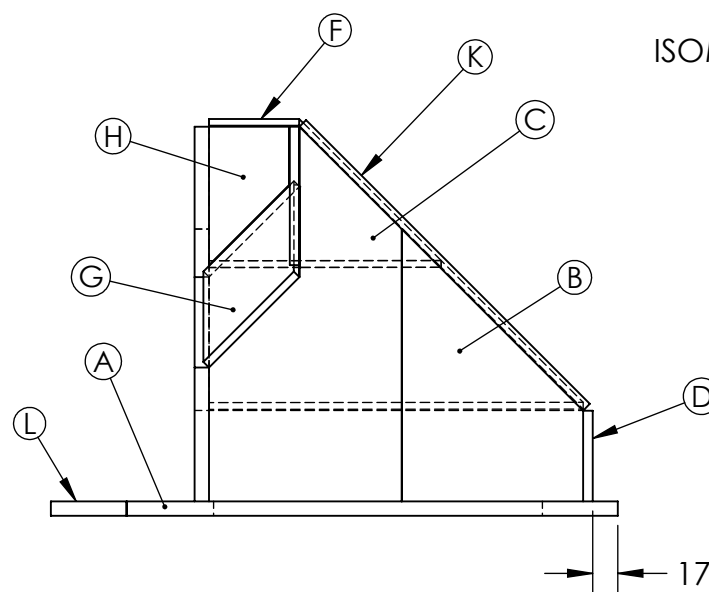
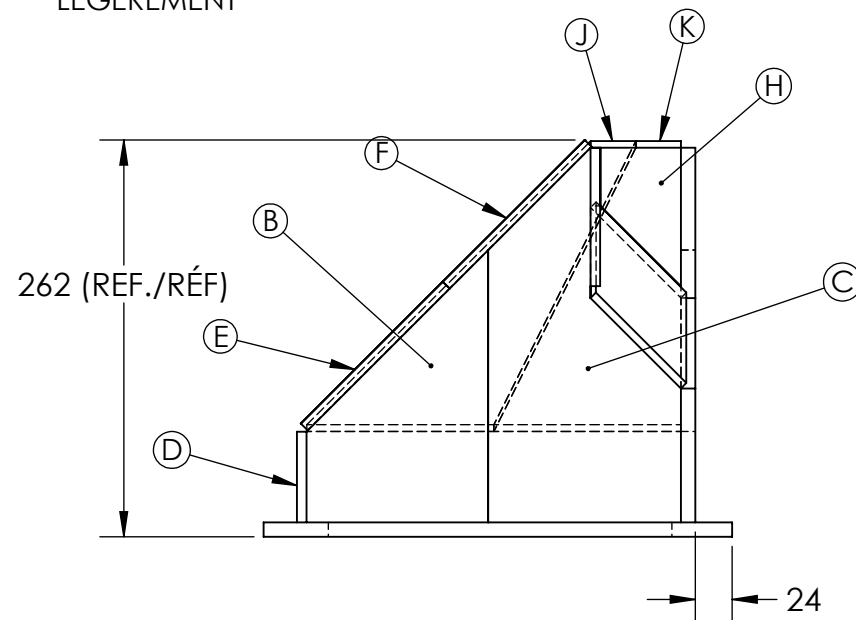

ISOMETRIC VIEW B / VUE ISOMÉTRIQUE B
SCALE 1:9

ALL DIMENSIONS IN MILLIMETERS/TOUTES LES DIMENSIONS SONT EN MILLIMÈTRES



TITLE: SKILLS ONTARIO 2023 - SECONDARY PREVIEW OCMT 2023 - APERÇU SECONDAIRE NATIONAL MINT / MONNAIE NATIONALE		SHEET # NO. DE PAGE: 1 OF 2	SIZE/TAILLE: B
DWG. NO.: ON2023-SP-1	REV.: 0	SCALE ÉCHELLE: 1:5	DESIGN BY: T. PUNTON DRAWN BY: J. HYDE DATE: 2023-01-15

4

3

2

1

4

3

2

1

BILL OF MATERIALS

ITEM / ARTICLE	DESCRIPTION	QTY	KG
A	PL 9.53 X 310 X 375	1	8.7
B	PL 6.35 X 120 X 180*	2	2.2
C	PL 6.35 X 128 X 248*	2	3.2
D	PL 6.35 X 60 X 248	2	1.5
E	PL 6.35 X 133 X 248	1	1.6
F	PL 6.35 X 133 X 154	1	1.0
G	PL 6.35 X 85 X 146	1	0.6
H	PL 6.35 X 53 X 92	2	0.5
J	PL 6.35 X 101 X 342	1	1.7
K	PL 6.35 X 124 X 265	1	1.6
L	PL 9.53 X 50 X 310	1	1.2
TOTAL ESTIMATED WEIGHT / POIDS TOTAL ESTIMÉ:			23.8

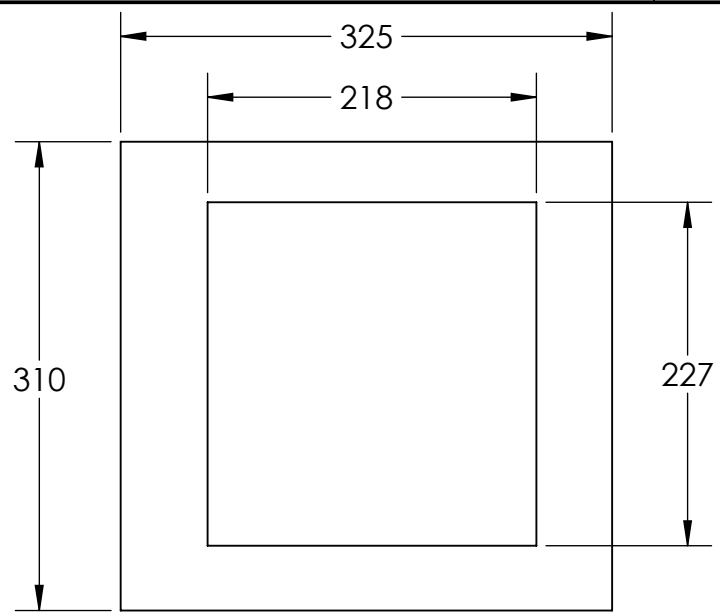

PART / ARTICLE A

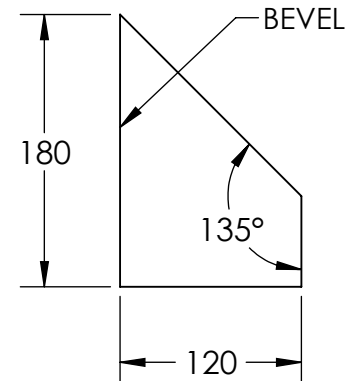

PART / ARTICLE B

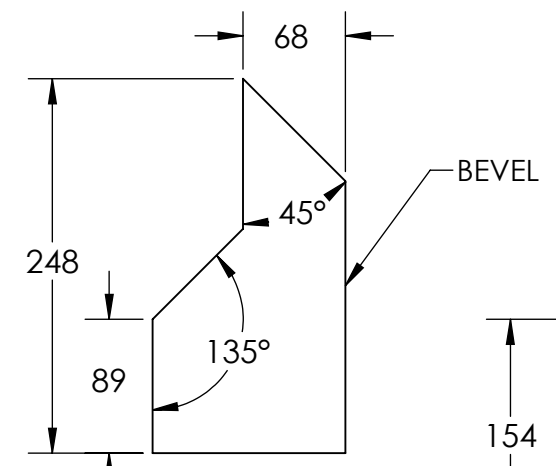

PART / ARTICLE C

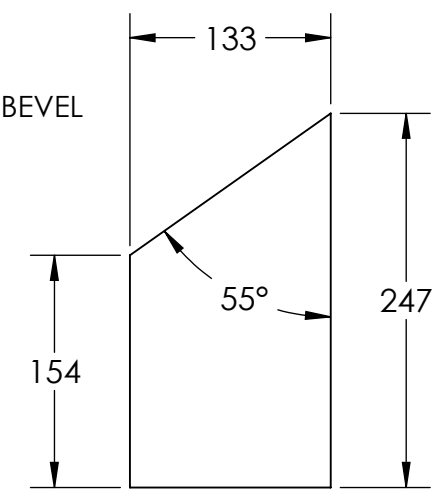

PART / ARTICLE E

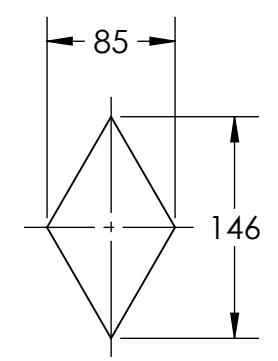

PART / ARTICLE G

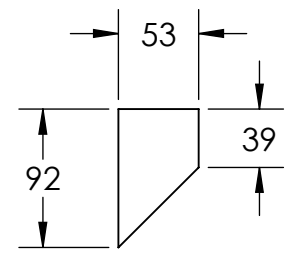

PART / ARTICLE H

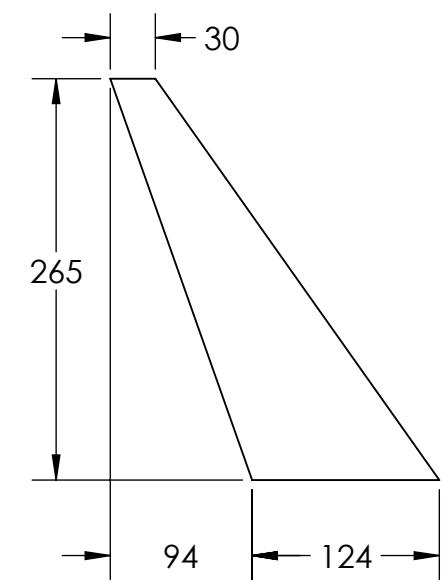

PART / ARTICLE J

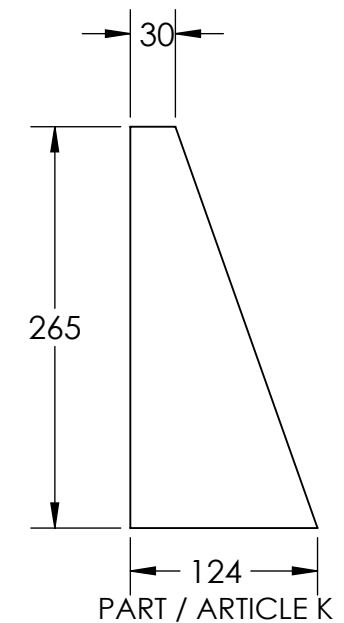

PART / ARTICLE K

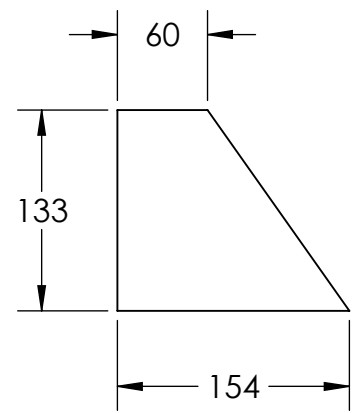

PART / ARTICLE F

NOTE:
 * BEVELS ON ITEMS B AND C WILL BE OPPOSITE SIDES FOR EITHER SIDE OF ASSEMBLY
 -TWO ITEM B CAN BE CUT IN HOLE /DROP FROM ITEM A
 -ITEMS WITHOUT A SKETCH ARE SQUARE / RECTANGULAR
 NOTE:
 * LES BISEAUX DES ÉLÉMENTS B ET C SERONT DES CÔTÉS OPPOSÉS POUR CHAQUE CÔTÉ DE L'ASSEMBLAGE
 -DEUX ITEM B FORMES COUPÉES DANS UN TROU DÉPOSÉ DE L'ARTICLE A
 -LES ÉLÉMENTS SANS CROQUIS SONT CARRÉS / RECTANGULAIRE

ALL DIMENSIONS IN MILLIMETERS/TOUTES LES DIMENSIONS SONT EN MILLIMÈTRES



TITLE: SKILLS ONTARIO 2023 - SECONDARY PREVIEW OCMT 2023 - APERÇU SECONDAIRE NATIONAL MINT / MONNAIE NATIONALE - PARTS / LES PIÈCES		SHEET # NO. DE PAGE: 2 OF 2	SIZE/TAILLE: B
DWG. NO.: ON2023-SP-1	REV.: 0	SCALE ÉCHELLE: 1:5	DESIGN BY: T. PUNTON DRAWN BY: J. HYDE DATE: 2023-01-15

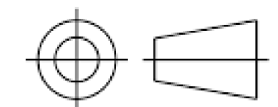

4

3

2

1