

2022 Virtual Landscape Design Competition

Competitor Package

HORTICULTURAL TRADES ASSOCIATION
landscapeontario.com
 Green for Life!

 **DynaScape**

Table of Contents

Introduction.....	2
Competition Objective.....	2
Client Wishlist.....	3
Drawing Requirements/Tips.....	4
Site Photos	5
Base Plan.....	7
Examples	8
Typical Landscape Design Process.....	9
References	9

Introduction

Welcome and congratulations on participating in the 2023 Virtual Skills Ontario Competition for Landscape Design! In this Package you will find: the Competition Objective, Client Wishlist, Drawing Requirements & Tips, Site Photos, Base Plan, Examples and Resources.

This contest will be judged by virtual submission. You will have one week to work on and submit your design via the dropbox link located at the end of the Scope document. Good luck with your landscape design and don't forget to have fun as you design!

Competition Objective

Showcase your landscape design skills by creating a finished landscape design for the residential backyard property provided. Your design should meet the clients wishlist, include labels and appropriate landscape symbols, graphics and patterns. You can complete your landscape design by hand or using computer design software such as DynaSCAPE or other. You will have 5 hours to complete your landscape design. Once complete or time runs out, submit your landscape

design and bubble diagram(s) as a PDF or JPEG file to the dropbox provided to you by Skills Ontario.

Client Wishlist

1. A landscape design for the full property as outlined by the property line
2. The proposed additional garage that is provided on the drawing is to remain as drawn
3. A contemporary style landscape with natural elements mixed in. (Consider using straight lines to modernize the landscape.)
4. A new design for a rectangular pool with a sheer descent waterfall on the backside
5. The existing pool fence and trees near the pool area as seen in the photo are to be removed.
6. Include a location for storing the pool equipment
7. Include 5 lounge chairs in the sunny area by the pool
8. Design a patio around the pool with a walkway to the new garage and house
9. Design a new fence for around the new pool area
10. Design a large deck near the house that the clients can use for entertaining for 10 people
11. Include a BBQ area
12. Do not draw/locate any elements/features over top of the septic outlets, tank or field
13. Design a fire pit area
14. Design privacy planting areas in the backyard to create privacy
15. Design a new border along the driveway
16. Design a front entrance walkway connecting the driveway to the main front door (consider plantings to go around the walkway or front door to make it a focal point)

17. Include planting areas (planting beds) in your design

Drawing Requirements/Tips

1. Important! Step one: Before starting the design, be sure to complete the title block.
2. Bubble Diagram: Create one or more bubble diagram(s) to organize your design components and inspire your final design. This is a very rough sketch to help you get started. Feel free to create a bubble diagram by hand or on the computer. You can submit a photo of your bubble diagram(s) if drawn by hand.
3. Base Plan Info: A base plan is provided to you as a PDF and DynaSCAPE file. You are welcome to use either as long as you draw your design to scale. We will be using metric scales.
4. Layers: Use appropriate layers to draw design elements to achieve the correct line weights.
5. Symbols: Use appropriate symbols for plants. Plants are to be shown at full mature size (shrubs and small trees) and at about $\frac{3}{4}$ mature size (large trees).
6. Labeling Plants: Label plants with generic names (i.e., 'Large Deciduous Shade Tree', 'Large Conifer', 'Large Palm', 'Medium Evergreen Shrub', 'Low Perennial', 'Med Ornamental Grass', 'Groundcover', 'Annuals', etc).
7. Labeling Hardscapes: Hardscape labels will be generic as well (i.e., 'Paving Stone Patio', or 'Pattern Concrete Walkway', etc.).
8. Patterns: Use appropriate patterns for hardscape materials (adjust pattern scale as needed).
9. Your design: does not need to be rendered (coloured) but can be if you have time.
10. Submission: Drawings will be judged and submitted as PDF files for the masterplan and JPEG or PDF files for the bubble diagram.

Tie breaker: The tie breaker will be based on the time your design was submitted (the time stamp on the file submission will be recorded by the judges).

****** Save your drawing often to avoid any chance of lost work! ******

Site Photos

Front yard with driveway



Backyard with existing pool to be replaced



North side yard showing main front entrance



North side yard

South side of house with garage



Base Plan

A base plan will be provided to you the morning of the competition via the email you have on file with Skills Ontario. The baseplan will come in two formats:

- An 8.5x11 PDF that you can print at home. The scale of this plan is 1:300.
 - Use this if you prefer to design by hand
- A DynaSCAPE file that contains the baseplan.
 - Use this if you prefer to design using landscape design computer software

Examples

Bubble Diagram

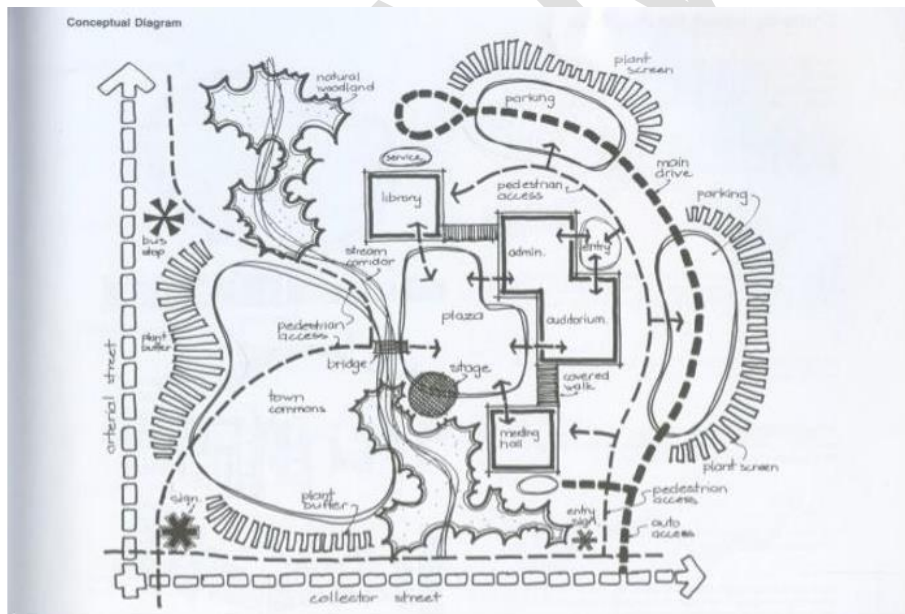

Plant Symbols

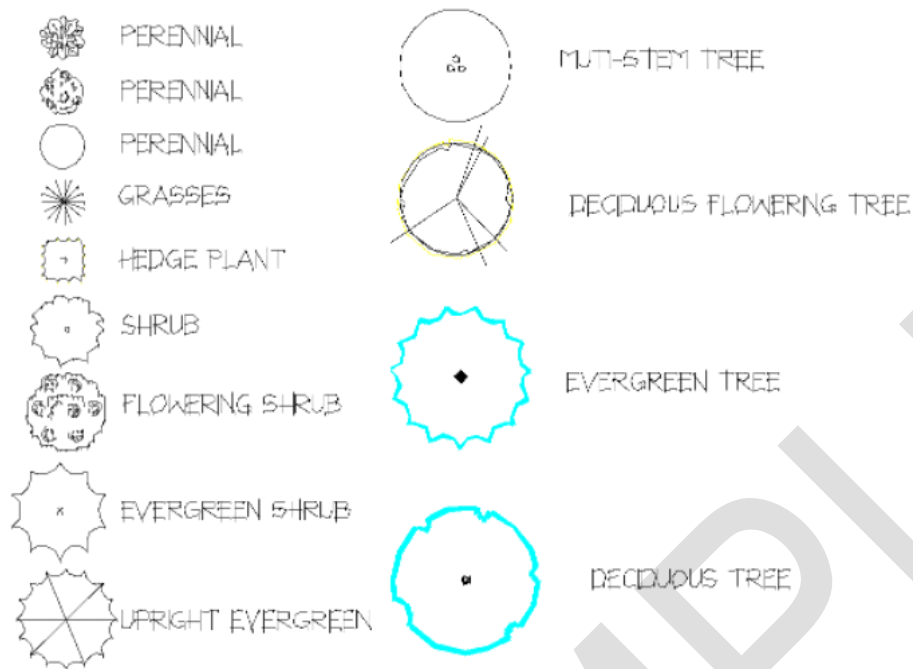

Typical Landscape Design Process

1. Property owner (potential client) contacts landscape designer for their expertise
2. Meeting is scheduled at the property to discuss site problems and client's ideas (see client wishlist)
3. Lot Plan/Property Survey supplied by owner (used to create baseplan)
4. Property measurements including elevations taken or provided (used to create baseplan)
5. Site Inventory and Analysis (you will need to use the information provided through photos)
6. Base map of the property to scale created (DynaSCAPE file provided)
7. One/Two bubble diagrams hand drawn on trace paper (you are responsible for this)
8. One hand-drawn or CAD/DynaSCAPE Landscape Design (you are responsible for this)
9. Follow up meeting to discuss the proposed Landscape Design

10. One revision included to finalize the plans
11. Estimate for construction to follow the final landscape plan as an option

Resources

www.worldplants.ca

<https://go.dynascape.com/rs/295-PFV-854/images/DynaScape%20Design%20QuickStart%20Guide.pdf>

EXAMPLE